

5.2 CMS accessories

CMS-ANT-SPEZ2/5M

Exterior antenna | 5 m cable

Communication

Communication standards	GSM / UMTS / LTE / WLAN
Frequencies	LTE 700, AMPS / GSM850, GSM900, GSM1800, PCS1900, 3G UMTS, 2.4 GHz WiFi, 2.6 GHz LTE
Antenna connector	SMA male
Impedance	50 Ω
Maximum power	50 W
Gain	2 dBi / 4 dBi

General data

Ambient temperature storage	-30 ... 70 °C
Ambient temperature operation	-20 ... 60 °C
Weight	330 g
Housing material	ABS

Product reference

Description	Type	5
Exterior antenna	CMS-ANT-SPEZ2/...M	✓

"..." list cable length to complete product references.



Standards and approvals

Approvals



5.2 CMS accessories

CMS-ANT-MAG2/2.5M

Magnetic pod antenna | 2.5 m cable

Communication

Communication standards	GSM / UMTS / LTE
Frequencies	699 ... 960 / 1710 ... 2690 MHz
Antenna connector	SMA male
Impedance	50 Ω
Maximum power	35 W
Gain	2.2 dBi

General data

Ambient temperature storage	-40 ... 85 °C
Ambient temperature operation	-40 ... 85 °C
Weight	50 g
Housing material	PA

Product reference

Description	Type	2.5
Magnetic pod antenna	CMS-ANT-MAG2/...M	✓

"..." list cable length to complete product references.



Standards and approvals

Approvals **CE**

5.2 CMS accessories

CMS-ANT-KAB

Antenna cable | SMA male / female | 5 m | 10 m | 20 m

Communication

Antenna connector	SMA male / female
Impedance	50 Ω

General data

Ambient temperature storage	-35 ... 80 °C
Ambient temperature operation	-35 ... 80 °C
Weight	180 g (5 m) / 270 g (10 m) / 728 g (20 m)
Material	PE

Product reference

Description	Type	5	10	20
Extension cable SMA male / female	CMS-ANT-KAB/...M	✓	✓	✓

Other cable length on request. Please contact support@comatreleco.com.

"..." list cable length to complete product references.



Standards and approvals

Approvals



5.2 CMS accessories

DR-15-24, DR-30-24

Power supply | 24 V DC

Power supply

Nominal voltage	230 V AC
Operating voltage range	85 ... 264 V AC
Power consumption AC	110 VA
Rated frequency	47 ... 63 Hz
Output voltage	24 V DC
Output voltage range	21.6 ... 26.4 V

General data

Ambient temperature storage	-40 ... 85 °C
Ambient temperature operation	-20 ... 60 °C
Conductor cross section	2.5 mm ²
Module width	fig. 1
Weight	65 g
Protection degree	IP20
Housing material	PA

Product reference

Description	Type
Power supply 15 W, 24 V DC	DR-15-24
Power supply 30 W, 24 V DC	DR-30-24

Other voltages on request. Please contact support@comatreleco.com.



fig. 1. Dimensions (mm)

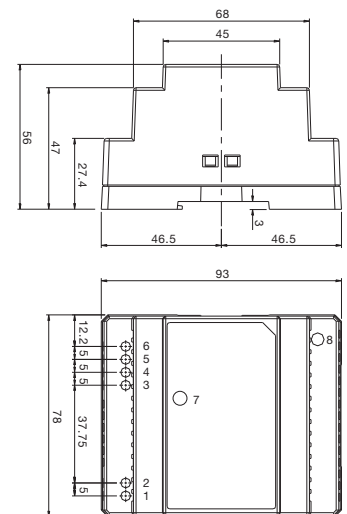
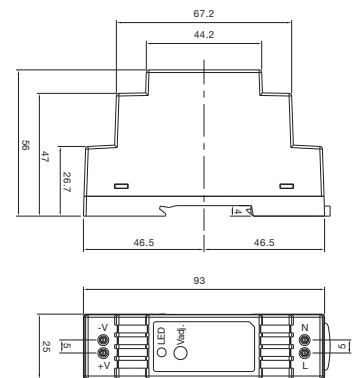

Standards and approvals

Approvals 

5.2 CMS accessories

MV-LKM-274

PT100 / PT1000 amplifier | 0 ... 10 V output

Power supply

Nominal voltage	24 V DC
Operating voltage range	15 ... 35 V DC
Power consumption DC	0.24 W

Outputs

Number of analogue outputs	1
Analogue output type	0 ... 10 V

General data

Ambient temperature storage	-25 ... 70 °C
Ambient temperature operation	-25 ... 70 °C
Conductor cross section	2.5 mm ²
Module width	fig. 2
Weight	60 g
Protection degree	IP20
Housing material	PC

Product reference

Description	Type
PT100 / PT1000 amplifier	MV-LKM-274

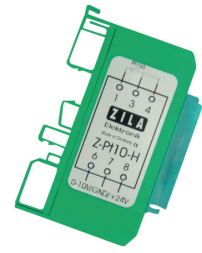

fig. 1. Wiring diagram

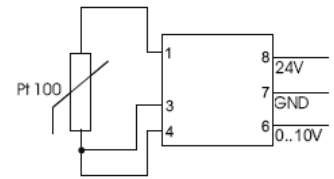
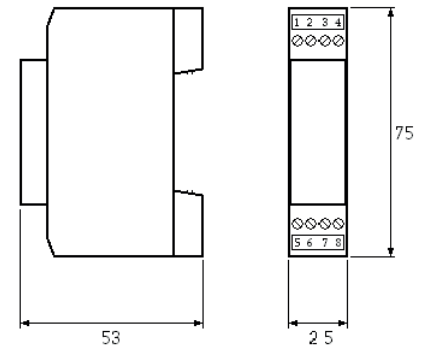

fig. 2. Dimensions (mm)



Standards and approvals

Approvals



5.2 CMS accessories

RF01-U, RF01-U2-D

Indoor temperature sensor | 0 ... 50 °C | 0 ... 10 V output

Power supply

Nominal voltage	24 V UC
Operating voltage range	22 ... 26 V UC
Power consumption DC	0.2 W

Outputs

Number of analogue outputs	1
Analogue output type	0 ... 10 V

General data

Ambient temperature storage	-20 ... 60 °C
Ambient temperature operation	-20 ... 60 °C
Conductor cross section	1.5 mm ²
Module width	fig. 2
Weight	67 g
Protection degree	IP54
Housing material	ABS

Product reference

Description	Type
Indoor temperature sensor	RF01-U
Indoor temperature sensor with display	RF01-U2-D



fig. 1. Wiring diagram

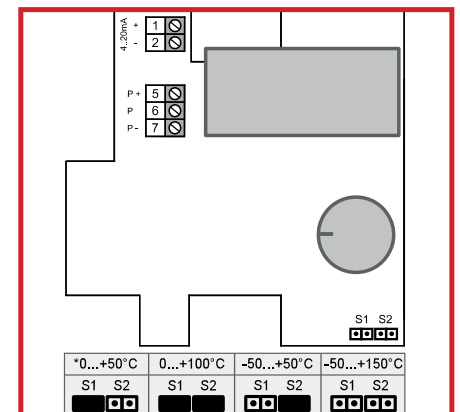
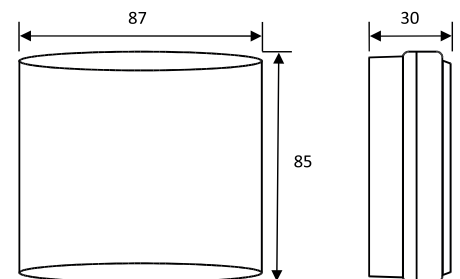

fig. 2. Dimensions (mm)



Standards and approvals

Approvals 

5.2 CMS accessories

RTBSB-001-010

Thermostat | 5 ... 30 °C | Cooling or heating | 1 CO

Outputs

Number of relay outputs	1 CO
Rated voltage	230 V AC
Rated current	10 A (Terminal 1) / 5 A (Terminal 3)
Rated load AC-1	2300 VA / 1150 VA

General data

Ambient temperature storage	-20 ... 60 °C
Ambient temperature operation	-20 ... 60 °C
Conductor cross section	1.5 mm ²
Weight	90 g
Protection degree	IP30
Housing material	ABS

Product reference

Description	Type
Thermostat	RTBSB-001-010



fig. 1. Wiring diagram

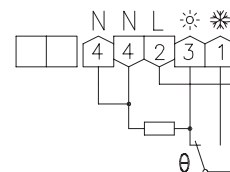

Standards and approvals

Approvals 

5.2 CMS accessories

WF50-EXT-U4

Exterior temperature sensor | -50 ... 50 °C | 0 ... 10 V output

Power supply

Nominal voltage	24 V DC
Operating voltage range	21.6 ... 26.4 V DC

Outputs

Number of analogue outputs	1
Analogue output type	0 ... 10 V

General data

Ambient temperature storage	-30 ... 70 °C
Ambient temperature operation	-30 ... 70 °C
Conductor cross section	1.5 mm ²
Module width	fig. 1
Weight	100 g
Protection degree	IP65
Housing material	PA

Product reference

Description	Type
Exterior temperature sensor	WF50-EXT-U4



fig. 1. Dimensions (mm)

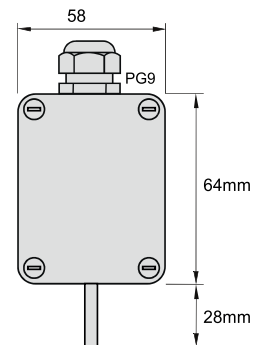

Standards and approvals

Approvals



KS-110**Temperature / humidity sensor | -40 ... 80 °C | 0 ... 100 % rH | 0 ... 10 V output | Cable length 2 m****Power supply**

Nominal voltage	24 V DC
Operating voltage range	12 ... 27 V DC
Power consumption DC	0.2 W

Outputs

Number of analogue outputs	2
Analogue output type	0 ... 10 V

General data

Ambient temperature storage	-40 ... 85 °C
Ambient temperature operation	-40 ... 85 °C
Weight	62 g
Protection degree	IP65

Product reference

Description	Type
Temperature / humidity sensor	KS-110

**Standards and approvals**Approvals **CE**

5.2 CMS accessories

PS1

Water level sensor | 0 ... 0.5 bar | 0 ... 10 V output

Power supply

Nominal voltage	24 V DC
Operating voltage range	12 ... 30 V DC

Outputs

Number of analogue outputs	1
Analogue output type	0 ... 10 V

General data

Ambient temperature storage	5 ... 70 °C
Ambient temperature operation	5 ... 70 °C
Weight	550 g
Protection degree	IP68

Product reference

Description	Type
Water level sensor	PS1

Sensors for other liquids on request. Please contact support@comatreleco.com.



Standards and approvals

Approvals **CE**



Kühn Controls AG

Notes:

You want more information about this product, please call us: tel: +49 (0)7082-940000 or send us a fax: +49 (0)7082-940001, or email: sales@kuehn-controls.de or visit our Website: www.kuehn-controls.de